

2nd LEVEL FLOOR PLAN

TOTAL FLOOR SPACE = 502 SQ. FT.
 TOTAL ATTIC SPACE = 440 SQ. FT.

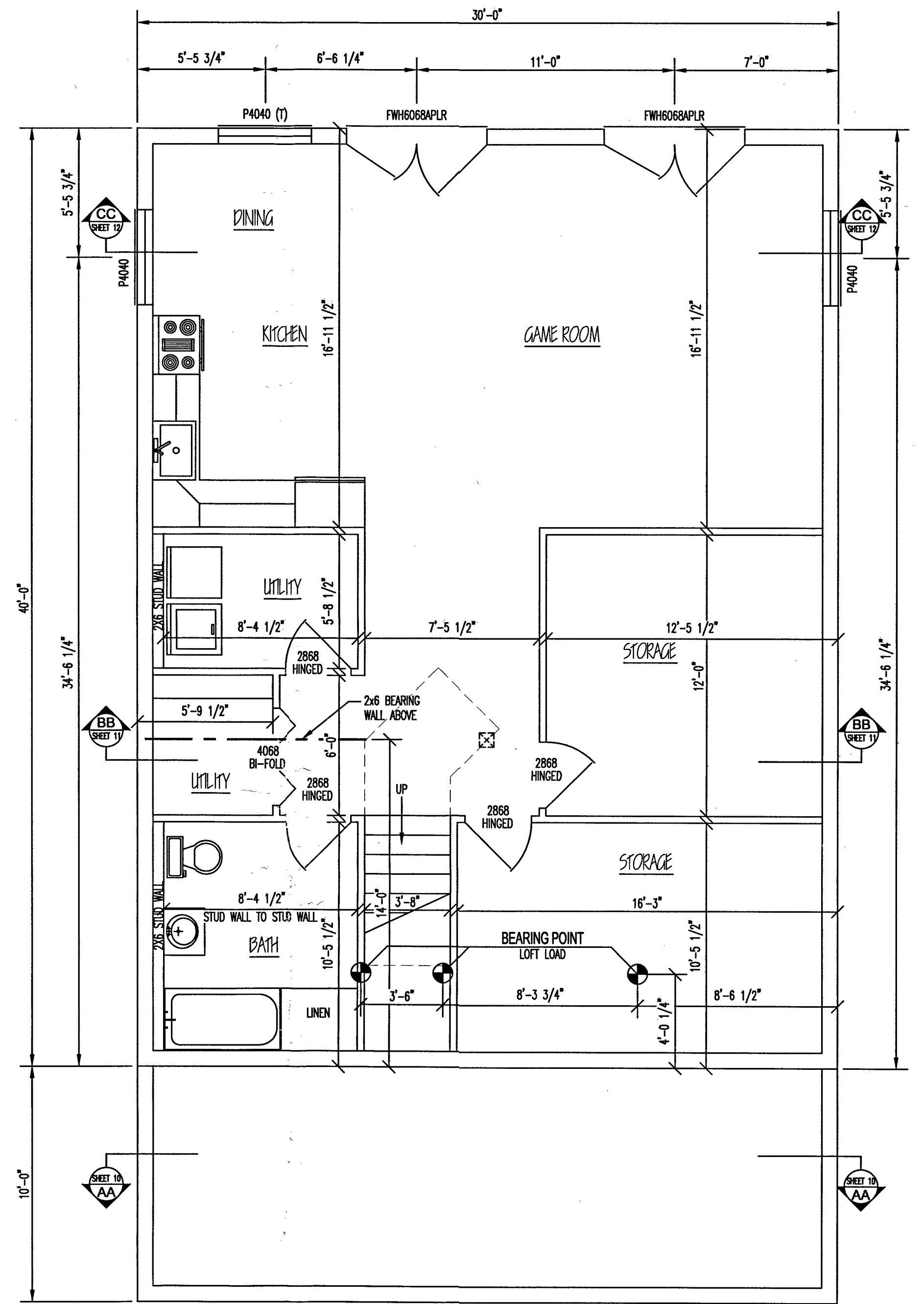

NOTE:
 ANY SUPPORT/MODIFICATIONS REQUIRED IN
 BASEMENT FOR BEARING POINTS ABOVE TO BE
 RESPONSIBILITY OF OWNER.

EXISTING BASEMENT FLOOR PLAN

ALL BASEMENT
 MATERIALS ARE BY
 OTHERS

INTERIOR FASTENERS	
- 3/8" x 8" LAGS :	PARTITION WALLS TO LOG WALL CONNECTION
- 16d CEMENT COATED SINKERS :	CONVENTIONAL FRAMING
- 10d FINISH NAILS :	INTERIOR DOOR JAMBS
- 8d FINISH NAILS :	INTERIOR TRIM
- 8d FINISH NAILS :	1x8 T&G WALL FINISH

FLOOR PLAN GENERAL NOTES	
- GENERAL SPECIFICATIONS :	SEE COVERSHEET.
- DETAILS :	REFER TO APPLICABLE DETAILS FOR FLOOR PLAN INFORMATION
- INTERIOR PARTITION HEIGHTS :	REFER TO SECTIONS FOR APPROPRIATE LOG COURSE HEIGHT. FINAL HEIGHT DETERMINED BY ACTUAL LOG COURSE STACK HEIGHT.
- MULLED WINDOWS :	WINDOWS MAY NEED MULLED ON SITE DUE TO SIZE OR TYPE.
- MATERIALS INCLUDED :	ALL DETAILS PERTAINING TO MATERIAL NOT SUPPLIED BY CLC MUST BE VERIFIED PRIOR TO ACTUAL CONSTRUCTION. SEE APPROPRIATE QUOTE AND ALL APPLICABLE CHANGE ORDERS FOR MATERIALS TO BE SUPPLIED BY CLC.

COPYRIGHT NOTICE © Copyright 2009 by Country Log Cabins

DO NOT SCALE DRAWING - CONTRACTOR TO VERIFY ALL DIMENSIONS IN FIELD

RESIDENCE FOR:
BOBBY BARY

PLAN NAME:
2nd LEVEL AND BASEMENT FLOOR PLANS

PRELIMINARY DATES: 8/12/09 FINAL PRELIM. DATES: _____ FINAL DATES: 9/1/09
 DRAWN BY: KH/SR MODEL BY: _____ DRAWN BY: J.L.K.
 SCALE: 1/4" = 1'-0"
 PROJ. NO. BARBORD-09A-631
 DWG. NO. CLC-350-2
 SHEET NO. 4 OF 12

Country Log Cabins

SALES REP. / DEALER:
KEVIN FOWLER

*All Country Log Cabins, we are dedicated to the highest standard of excellence for our customers. As part of the Country Log Cabins organization, I am proud to have worked on the plans for your home. Should we fail to meet your expectations, please notify your Log Home Representative as your satisfaction is our highest priority. We look forward to helping you make your log home dream a reality!
 Drawn by: Jim Hesse