

Soils Map

Boundary Lines Are Approximate

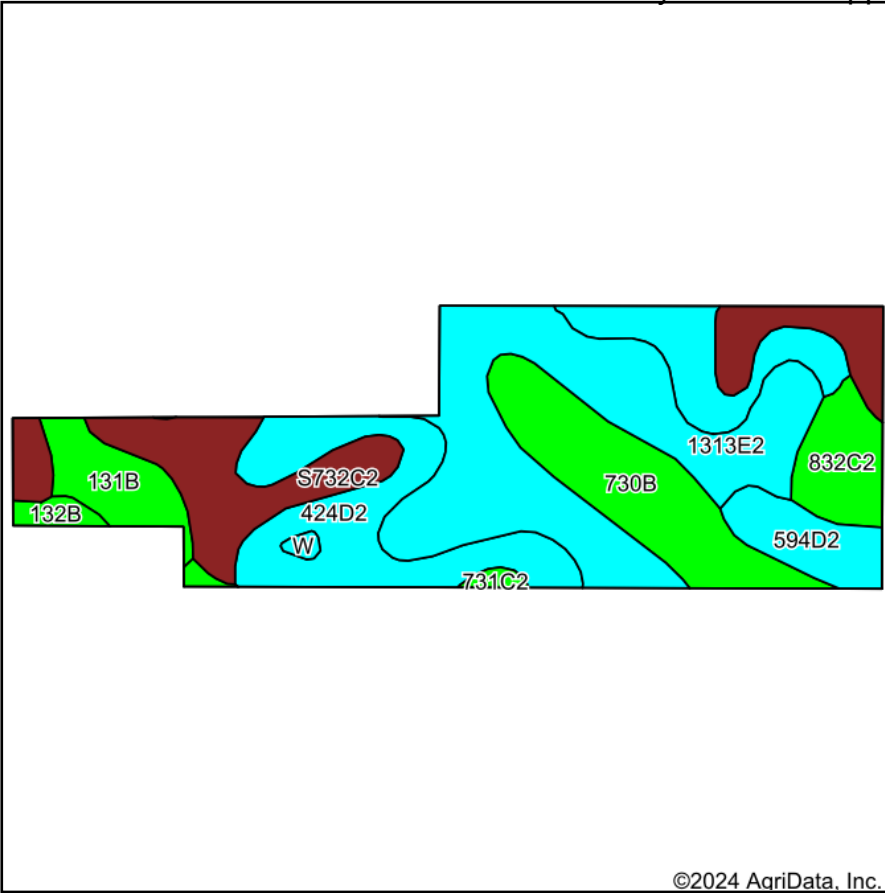

Soils data provided by USDA and NRCS.

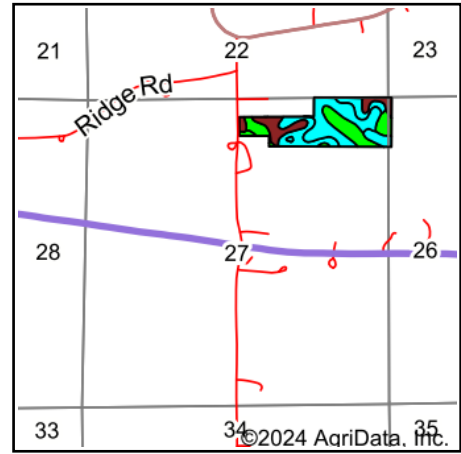

State: **Iowa**
 County: **Wapello**
 Location: **27-72N-15W**
 Township: **Polk**
 Acres: **39**
 Date: **7/22/2024**

Hawkeye Farm Mgmt & Real Estate

United Country Real Estate
 22 N Main, Albia IA Phone: 641-932-7796
 Email: hawkeye@uciowa.com
 On the web: www.uciowa.com
 www.iowawhitealfarms.com

Maps Provided By:



Area Symbol: IA179, Soil Area Version: 32

Code	Soil Description	Acres	Percent of field	CSR2 Legend	Non-Irr Class *c	CSR2**	CSR	*n NCCPI Corn	*n NCCPI Soybeans	
1313E2	Munterville silt loam, 9 to 18 percent slopes, moderately eroded	11.14	28.5%		Vle	22	5	56	39	
424D2	Lindley-Keswick loams, 9 to 14 percent slopes, moderately eroded	8.88	22.8%		IVe	27	15	63	50	
S732C2	Weller silty clay loam, 5 to 9 percent slopes, moderately eroded	6.50	16.7%		IIle	59		81	67	
730B	Nodaway-Cantril complex, 2 to 5 percent slopes	5.36	13.7%		IIw	80	63	70	65	
832C2	Weller silty clay loam, terrace, 5 to 9 percent slopes, moderately eroded	2.11	5.4%		IVe	61	30	84	69	
131B	Pershing silt loam, 2 to 5 percent slopes	2.06	5.3%		IIle	70	65	74	59	
594D2	Galland loam, heavy loess, 9 to 14 percent slopes, moderately eroded	1.99	5.1%		IVe	19	5	68	49	
132B	Weller silt loam, 2 to 5 percent slopes	0.45	1.2%		IIle	67	55	89	80	
731C2	Pershing silty clay loam, 5 to 9 percent slopes, moderately eroded	0.35	0.9%		IIle	62	40	68	56	
W	Water	0.16	0.4%			0	0			
Weighted Average						*-	42.6	*-	*n 67	*n 53.4

**IA has updated the CSR values for each county to CSR2.

*- CSR weighted average cannot be calculated on the current soils data, use prior data version for csr values.

*n: The aggregation method is "Weighted Average using all components"

*c: Using Capabilities Class Dominant Condition Aggregation Method

*- Non Irr Class weighted average cannot be calculated on the current soils data due to missing data.