

Soils Map

Boundary Lines Are Approximate

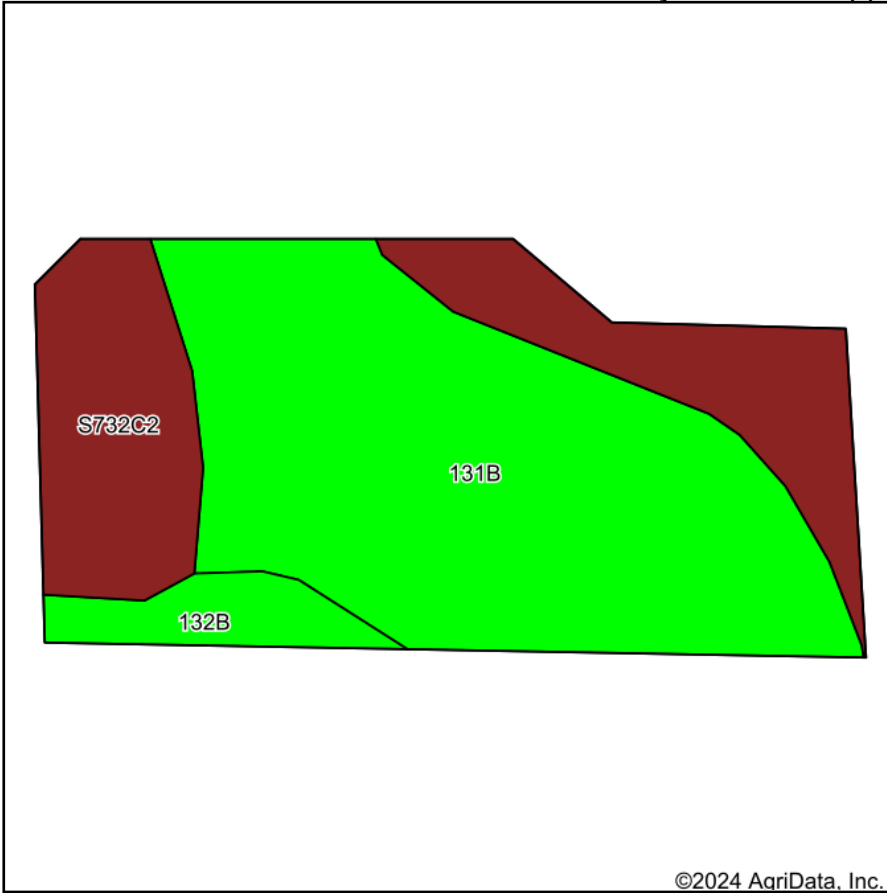

Soils data provided by USDA and NRCS.

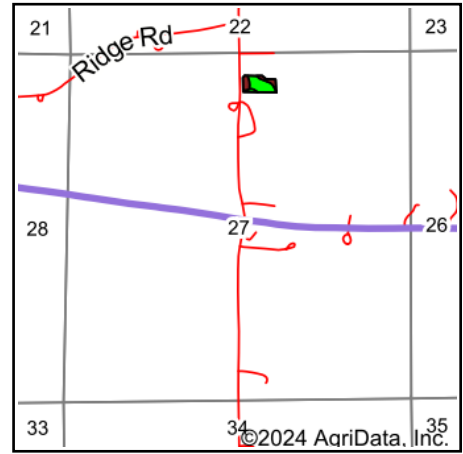

State: **Iowa**
 County: **Wapello**
 Location: **27-72N-15W**
 Township: **Polk**
 Acres: **2.68**
 Date: **7/22/2024**

Hawkeye Farm Mgmt & Real Estate



22 N Main, Albia IA Phone: 641-932-7796
 Email: hawkeye@uciowa.com
 On the web: www.uciowa.com
www.iowawhitehillfarms.com

Maps Provided By:



© AgriData, Inc. 2023

www.AgriDataInc.com



Area Symbol: IA179, Soil Area Version: 32

Code	Soil Description	Acres	Percent of field	CSR2 Legend	Non-Irr Class *c	CSR2**	CSR	*n NCCPI Corn	*n NCCPI Soybeans
131B	Pershing silt loam, 2 to 5 percent slopes	1.66	61.9%		IIIe	70	65	74	59
S732C2	Weller silty clay loam, 5 to 9 percent slopes, moderately eroded	0.86	32.1%		IIIe	59		81	67
132B	Weller silt loam, 2 to 5 percent slopes	0.16	6.0%		IIIe	67	55	89	80
Weighted Average						3.00	66.3	*n 77.1	*n 62.8

**IA has updated the CSR values for each county to CSR2.

*- CSR weighted average cannot be calculated on the current soils data, use prior data version for csr values.

*n: The aggregation method is "Weighted Average using all components"

*c: Using Capabilities Class Dominant Condition Aggregation Method