

SURVEY MAP

JOHN & MRS PRICE LOT
MIDDLEBURG STREET
LIBERTY, KENTUCKY

THE MAPMAKER

RICHARD ALLEN MONTGOMERY

REGISTERED LAND SURVEYOR # 1963
REGISTERED PROFESSIONAL ENGINEER 12034
113 RANDOLPH STREET LIBERTY KY 42839
(800) 787-8437 BUSINESS 787-8246 HOME

SCALE	AREA	DATE	DRAWN BY
1" = 40'	0.32 AC ±	1-3-2001	Richard A. Montgomery

SURVEYORS CERTIFICATE

I do here certify this to be a true and accurate plat of a survey by me on the date shown. The monuments have been placed as found as noted. The courses unadjusted.

Richard A. Montgomery

100 OF SURVEY *Landmark*

ANGULAR CLOSURE	00°00'31"
RATIO OF CLOSURE	1:14,785
NUMBER OF ANGLES	4
PERIMETER	896'

OWNER'S CERTIFICATE

I, WE do hereby certify that we are the owners of the property shown herein by record of *Lucy Corby* dated *26c 4, 1938* and of record in deed book *57* at page *577* office of the CLERK of *CASSY* COUNTY, KENTUCKY hereby adopt this survey.

Lucy Corby Executor of *Price*

VICINITY MAP

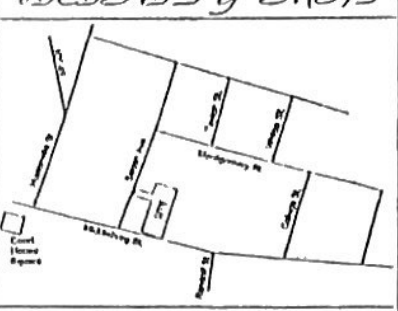

Note 1
This survey is reference to the State Plane Coordinate Grid.

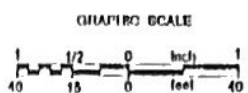

URBANCASS SURVEY

- SURVEY LEGEND**
- - Found Monument as Noted
 - - Set 5/8" Rebar and Cap Stamped RAM PLB 1953
 - - Unmarked Points

Note 2:

This triangle is a conveyance from John Price to Wofford Bros. D.B. 73 pg. 817. The right to join the existing wall was reserved in said deed.

