

Soils Map

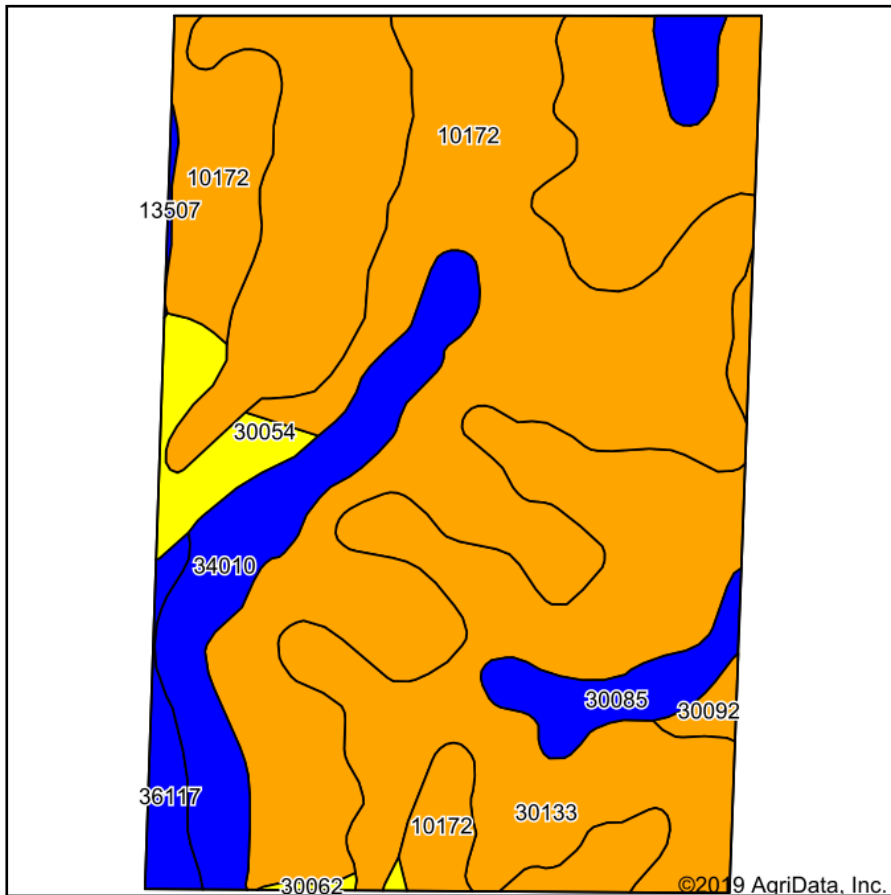

Soils data provided by USDA and NRCS.

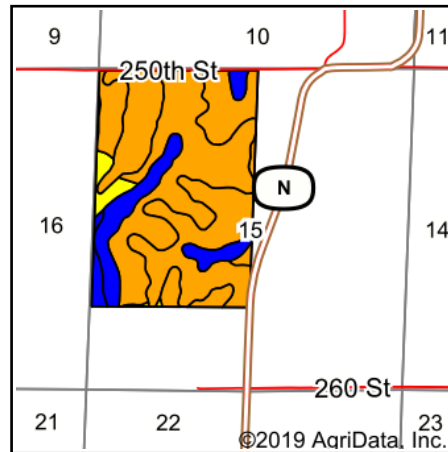

State: **Missouri**
 County: **Gentry**
 Location: **15-64N-31W**
 Township: **Bogle**
 Acres: **236.75**
 Date: **9/10/2019**

United Country
 Property Solutions, LLC

Maps Provided By:
surety
 CUSTOMIZED ONLINE MAPPING
 © AgriData, Inc. 2019 www.AgriDataInc.com



Area Symbol: MO075. Soil Area Version: 20													
Code	Soil Description	Acres	Percent of field	Non-Irr Class Legend	Non-Irr Class *c	Common bermudagrass	Orchardgrass red clover	Tall fescue	Warm season grasses	Alfalfa hay	Caucasian bluestem	*n NCCPI Soybeans	
30133	Lamoni clay loam, 5 to 9 percent slopes, moderately eroded	98.32	41.5%		IIIe							50	
10172	Shelby clay loam, 9 to 14 percent slopes, moderately eroded	96.04	40.6%		IIIe							51	
34010	Humeston silt loam, 0 to 2 percent slopes, rarely flooded	19.37	8.2%		IIw		8	7	8	9		71	
30085	Grundy silt loam, 2 to 5 percent slopes	9.73	4.1%		IIe							64	
30054	Gara clay loam, 9 to 14 percent slopes, eroded	6.61	2.8%		IVe		7	7	7	8	7	8	52
36117	Nodaway silt loam, heavy till, 0 to 2 percent slopes, occasionally flooded	4.26	1.8%		IIw							81	
30092	Grundy silty clay loam, 5 to 9 percent slopes, moderately eroded	1.51	0.6%		IIIe							67	
30062	Gara loam, 9 to 14 percent slopes	0.53	0.2%		IVe							60	
13507	Bremer silty clay loam, 0 to 2 percent slopes, rarely flooded	0.38	0.2%		IIw		8	7	8	9		57	
Weighted Average							0.9	0.8	0.9	1	0.2	0.2	*n 53.5

*n: The aggregation method is "Weighted Average using major components"

*c: Using Capabilities Class Dominant Condition Aggregation Method

Soils data provided by USDA and NRCS.