

COLORADO DIVISION OF WATER RESOURCES

NEW

THIS FORM MUST BE SUBMITTED PRIOR TO THE EXPIRATION OF THE PERMIT. TYPE OR PRINT IN BLACK INK.

101 Columbine Bldg., 1845 Sherman St. Denver, Colorado 80203

STATEMENT OF BENEFICIAL USE OF GROUND WATER AMENDMENT OF EXISTING RECORD

PERMIT NUMBER 62957



STATE OF COLORADO } COUNTY OF Pitkin } SS.

THE AFFIANT(S) Walter L. Osborn whose address is Box 281 Snowmass Colo. 81654

being duly sworn upon oath, deposes and says that he (they) is (are) the owner(s) of the well described hereon; the well is located in the N.W 1/4 of the N.W 1/4 of Section 27, Township 8 S, Range 86 W, 6th P.M. at distances of 1103 feet from the North section line and 1000 feet from the West section line; the total depth of the well is 65 feet; water from this well

was first applied to a beneficial use for the purpose(s) described herein on the 19th day of October, 1972. the maximum sustained pumping rate of the well is 13 gallons per minute, the pumping rate claimed hereby is 13 gallons per minute; the average annual amount of water to be diverted is 3/4 acre-feet; for which claim is hereby made for Domestic purpose(s); the legal description of the land on which the water from this well is to be used is As per Attached!

which totals 3.96 acres and which is illustrated on the map on the reverse side of this form; that this well was completed in compliance with the permit approved therefor; this statement of beneficial use of ground water is filed in compliance with law; he (they) has (have) read the statements made hereon; knows the content thereof; and that the same are true of his (their) knowledge.

Signature(s) [Handwritten Signature]

Subscribed and sworn to before me on this 1st day of December, 1972

My Commission expires: 12/20/73 (Seal) [Handwritten Signature] Notary Public

ACCEPTED FOR FILING IN THE OFFICE OF THE STATE ENGINEER OF COLORADO ON THIS DAY OF 19

STATE ENGINEER

FOR OFFICE USE ONLY. Prior Date, Well Use 0, 1/4, 1/4, 1/4, Sec., T., R., P.M., Yield, W.D. 5-38, Co. H9, Index.

THE LOCATION OF THE WELL MUST BE SHOWN AND THE AREA ON WHICH THE WATER IS USED MUST BE SHADED OR CROSS-HATCHED ON THE DIAGRAM BELOW.

This diagram represents nine (9) sections. Use the **CENTER SQUARE** (one section) to indicate the location of the well, if possible.

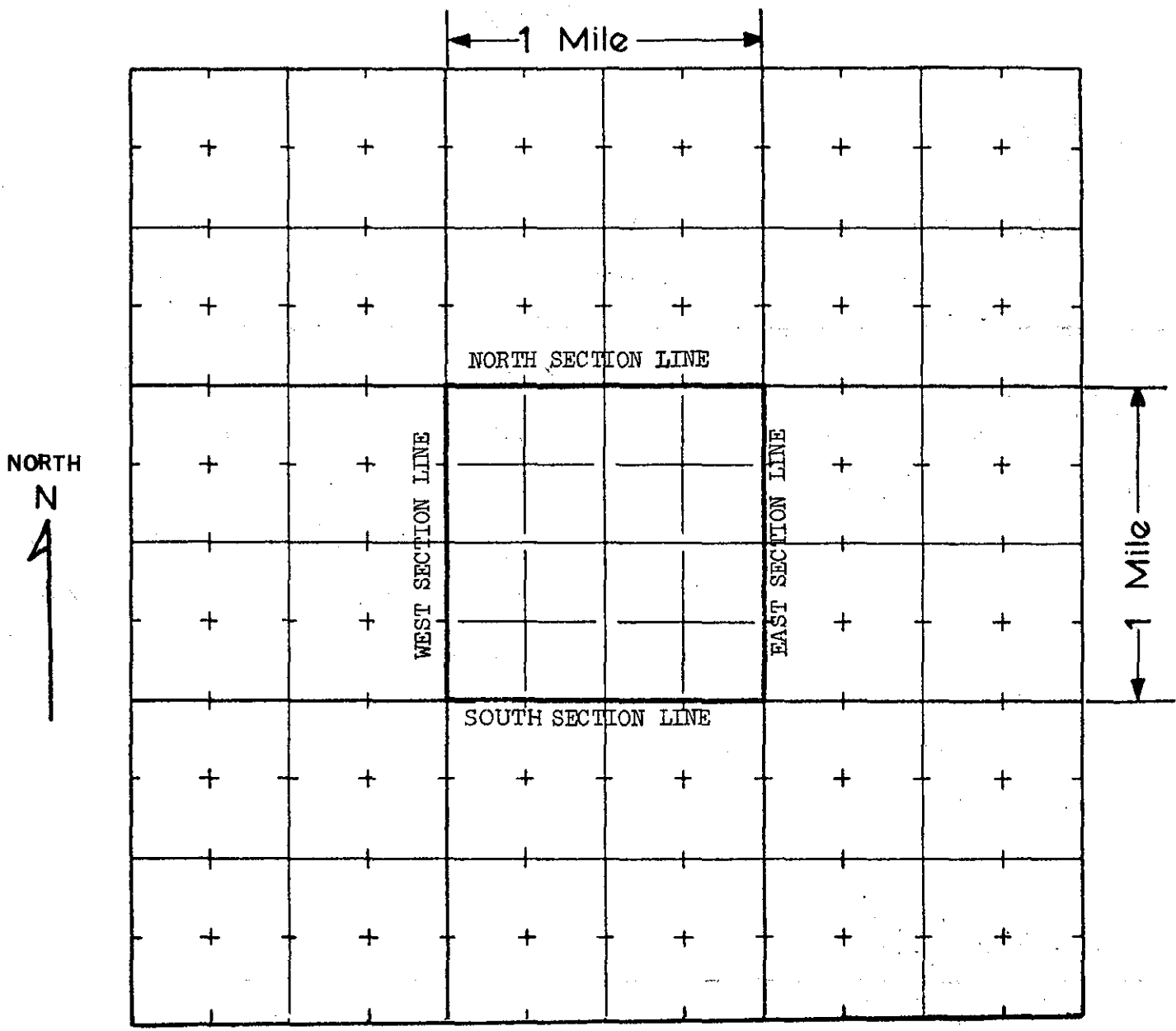

THE SCALE OF THE DIAGRAM IS TWO INCHES EQUALS ONE-MILE

Meter Serial No. _____ Flow Meter Electric Meter Fuel Meter

Owner of land on which water is being used _____

WATER EQUIVALENTS TABLE (Rounded Figures)

- An acre-foot covers 1 acre of land 1 foot deep.
- 1 cubic foot per second (cfs) . . . 449 gallons per minute (gpm).
- 1 acre-foot . . . 43,560 cubic feet . . . 325,900 gallons.
- 1,000 gpm pumped continuously for one day produces 4.42 acre-feet.
- 100 gpm pumped continuously for one year produces 160 acre-feet.

COLORADO DIVISION OF WATER RESOURCES

101 Columbine Bldg., 1845 Sherman St.
Denver, Colorado 80203

THIS FORM MUST BE SUBMITTED
WITHIN 60 DAYS OF COMPLETION
OF THE WORK DESCRIBED HERE-
ON. TYPE OR PRINT IN BLACK
INK.

WELL COMPLETION AND PUMP INSTALLATION REPORT

PERMIT NUMBER 62957

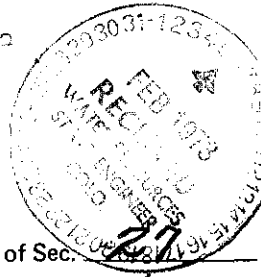

WELL OWNER Alvin J. Bionaz NW 1/4 of the NW 1/4 of Sec. 27

ADDRESS Box 26 Snowmass Colo T. 8 S, R. 86 W, 6th P.M.

DATE COMPLETED DEC 18, 1972

HOLE DIAMETER
6 3/4 in. from 0 to 55 ft.

WELL LOG

From	To	Type and Color of Material	Water Loc.
<u>0</u>	<u>55</u>	<u>GRAVELS</u>	<u>50</u>

_____ in. from _____ to _____ ft.
_____ in. from _____ to _____ ft.

CASING RECORD: Plain Casing
Size 5 1/2 & kind .0250 from 0 to 40 ft
Size _____ & kind _____ from _____ to _____ ft
Size _____ & kind _____ from _____ to _____ ft

Perforated Casing
Size 5 1/2 & kind .0250 from 40 to 55 ft
Size _____ & kind _____ from _____ to _____ ft
Size _____ & kind _____ from _____ to _____ ft

GROUTING RECORD
Material Clay
Intervals 0-20'
Placement Method _____

GRAVEL PACK: Size _____
Interval _____

TEST DATA
Date Tested DEC 18, 1972
Static Water Level Prior to Test 20' ft
Type of Test Pump BAILER
Length of Test 2 HRS
Sustained Yield (Metered) 9 G.P.M.
Final Pumping Water Level 55'

TOTAL DEPTH 55
Use additional pages necessary to complete log.

PUMP INSTALLATION REPORT

Pump Make _____
 Type _____
 Powered by _____ HP _____
 Pump Serial No. _____
 Motor Serial No. _____
 Date Installed _____
 Pump Intake Depth _____
 Remarks _____

WELL TEST DATA WITH PERMANENT PUMP

Date Tested _____
 Static Water Level Prior to Test _____
 Length of Test _____ Hours
 Sustained yield (Metered) _____ GPM
 Pumping Water Level _____
 Remarks _____

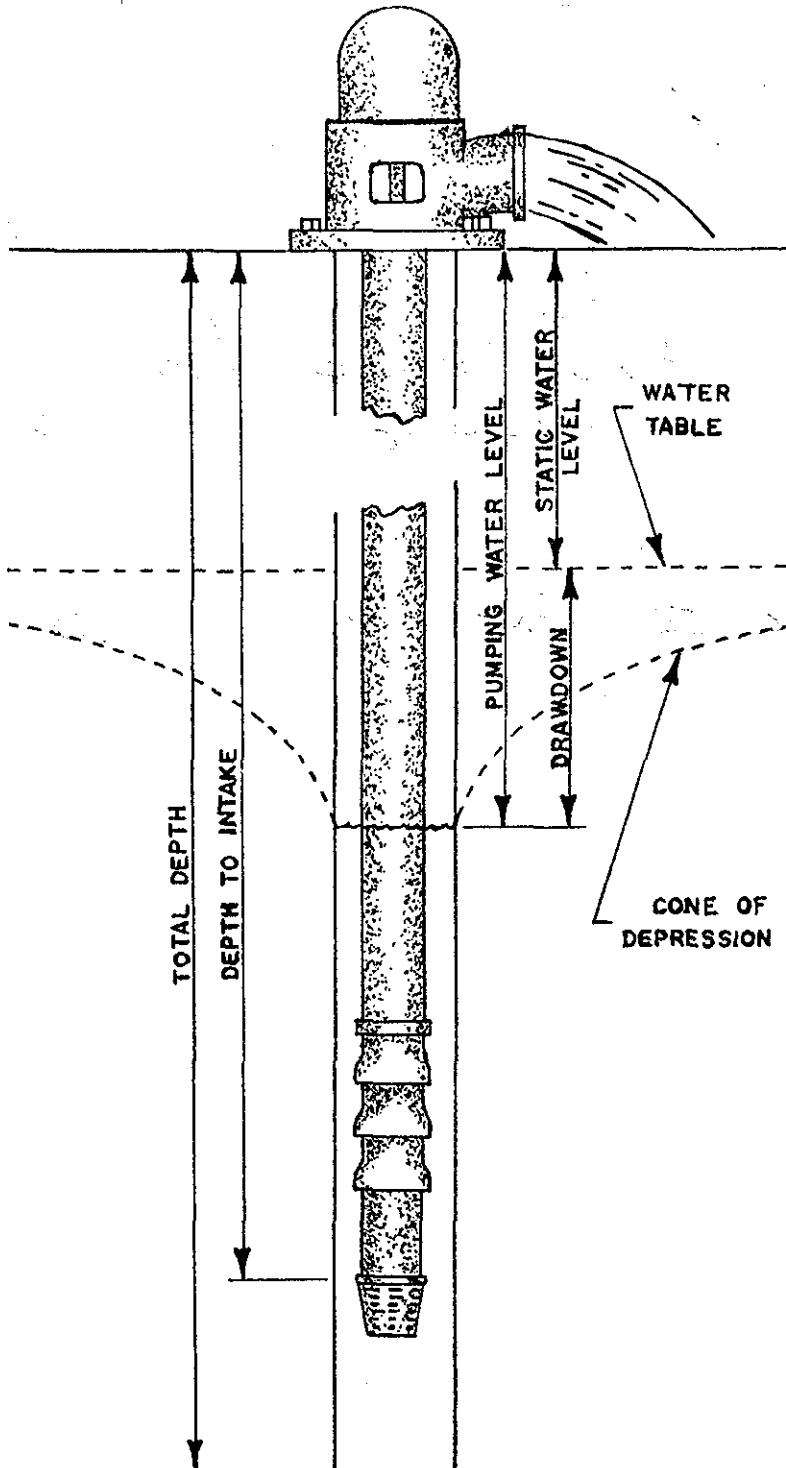

CONTRACTORS STATEMENT

The undersigned, being duly sworn upon oath, deposes and says that he is the contractor of the well or pump installation described hereon; that he has read the statement made hereon; knows the content thereof, and that the same is true of his own knowledge.

Signature Mountain Drilling Co License No. 697

State of Colorado, County of Garfield SS

Subscribed and sworn to before me this 3 day of Feb., 1973

My Commission expires: June 12, 1976

Notary Public Margaret K. Murray

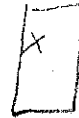

RECEIVED
JUN 14 1972

WATER RESOURCES
STATE ENGINEER
COLO.

TYPE OR PRINT IN BLACK INK. APPLICATION MUST BE COMPLETED BEFORE ACCEPTANCE.

APPLICATION FOR:

- A PERMIT TO USE GROUND WATER
- A PERMIT TO CONSTRUCT A WELL REPLACEMENT FOR NO. _____
- A PERMIT TO INSTALL A PUMP
- OTHER _____

GROUND WATER TO BE USED FOR:

- DOMESTIC (1) _____ COMMERCIAL (4)
- LIVESTOCK (2) _____ INDUSTRIAL (5)
- MUNICIPAL (8) _____ IRRIGATION (6)
- OTHER For Household Use Only

APPLICANT Alvin J Bionaz

WELL LOCATION
COUNTY Pitkin

Street Address Box 26

NW $\frac{1}{4}$ of the NW $\frac{1}{4}$ of Section 27

City & State Snowmass, Colo. 81654

T. 8 S, R. 86 W, 6th P.M.

Telephone No. 927-3548

NAME OF AQUIFER GROUND WATER IS TO BE OBTAINED

IN ADDITION TO THE ABOVE, THE WELL MUST BE LOCATED WITH REFERENCE TO GOVERNMENT SURVEY CORNERS, MONUMENTS OR SECTION LINES BY DISTANCE AND BEARING (DOMESTIC WELLS MAY BE LOCATED BY LOT, BLOCK, & SUBDIVISION.)

FROM: Gravels

PROPOSED TOTAL DEPTH OF WELL 60 Ft.

1103 ft. from North section line
(North or South)

ESTIMATED MAXIMUM PUMPING RATE 15 GPM

1000 ft. from West section line
(East or West)

AVERAGE ANNUAL AMOUNT OF GROUND WATER TO BE

APPROPRIATED 10.4^{A20} 3/4 Acre-feet

LOT _____ BLOCK _____ FILING # _____

ANTICIPATED GROUT PROGRAM

SUBDIVISION _____

Material Cement

Ground Water Basin Colo River

Intervals 10-20

Water Mgmt. Dist. 38

Placement Method SACK

Anticipated drilling date _____ 19 72

PROPOSED CASING:

Owner of land on which well is located: Same

Plain 7 in. from 0 ft. to 50 ft.

Other water rights on this land None

Perf. 7 in. from 50 ft. to 60 ft.

_____ in. from _____ ft. to _____ ft.

Driller Colleen Delg. Co. No. 634

Alvin J Bionaz
Signature of Applicant

Address Carbondale Colo.

IF WELL IS USED FOR IRRIGATION, BACK SIDE OF THIS APPLICATION MUST BE COMPLETED. 33506

FOR OFFICE USE ONLY

CONDITIONS OF APPROVAL

APPLICATION APPROVED: VALID FOR TWO (2) YEARS AFTER DATE ISSUED UNLESS EXTENDED FOR GOOD CAUSE SHOWN TO THE ISSUING AGENCY.

This well shall be used in such a way as to not cause material injury to existing water rights. The issuance of this permit does not assure the applicant that no injury will occur to another vested water right or preclude another owner of a vested water right from seeking relief in a civil court action

PERMIT NO. 62957

DATE ISSUED AUG 4 1972

Approved for household use only, for one (1) single family dwelling and not to be used for irrigation. The return flow from the use of this well must be returned to the same stream system in which the well is located.

[Signature]
STATE ENGINEER
BY _____

THE LOCATION OF THE PROPOSED WELL MUST BE SHOWN AND THE AREA TO BE IRRIGATED MUST BE SHADED OR CROSS-HATCHED ON THE DIAGRAM BELOW

This diagram represents nine (9) sections. Use the CENTER SQUARE (one section) to indicate the location of the well, if possible.

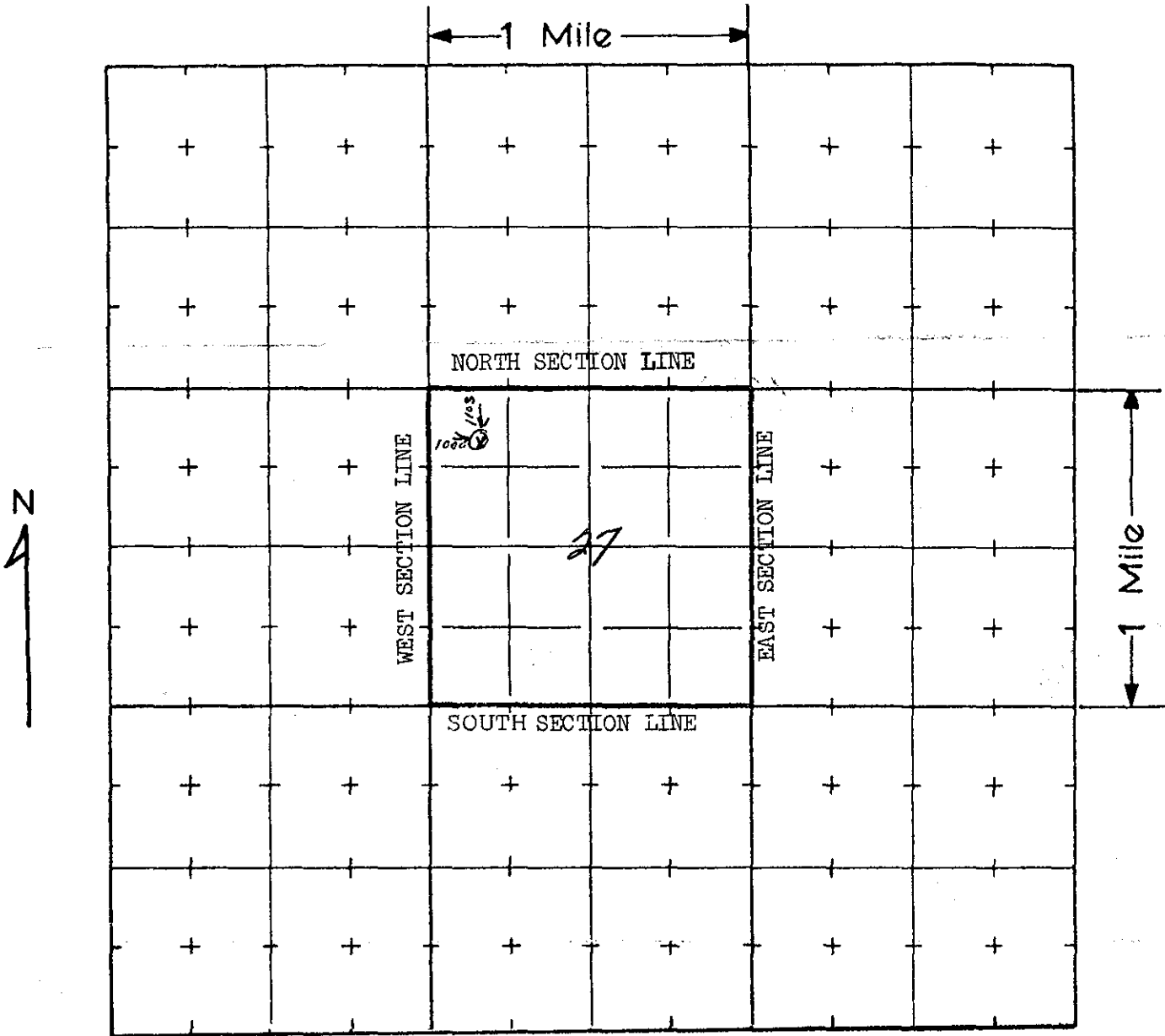

THE SCALE OF THE DIAGRAM IS TWO INCHES EQUALS ONE-MILE

Owner of irrigated land _____ Number of acres to be irrigated _____

Legal description of irrigated land _____

WATER EQUIVALENTS TABLE (Rounded Figures)

- An acre-foot covers 1 acre of land 1 foot deep.
- 1 cubic foot per second (cfs) 449 gallons per minute
- 1 acre-foot 43,560 cubic feet 325,900 gallons.
- 1,000 gpm pumped continuously for one day produces 4.42 acre-feet.
- 100 gpm pumped continuously for one year produces 160 acre-feet.