

Soils Map

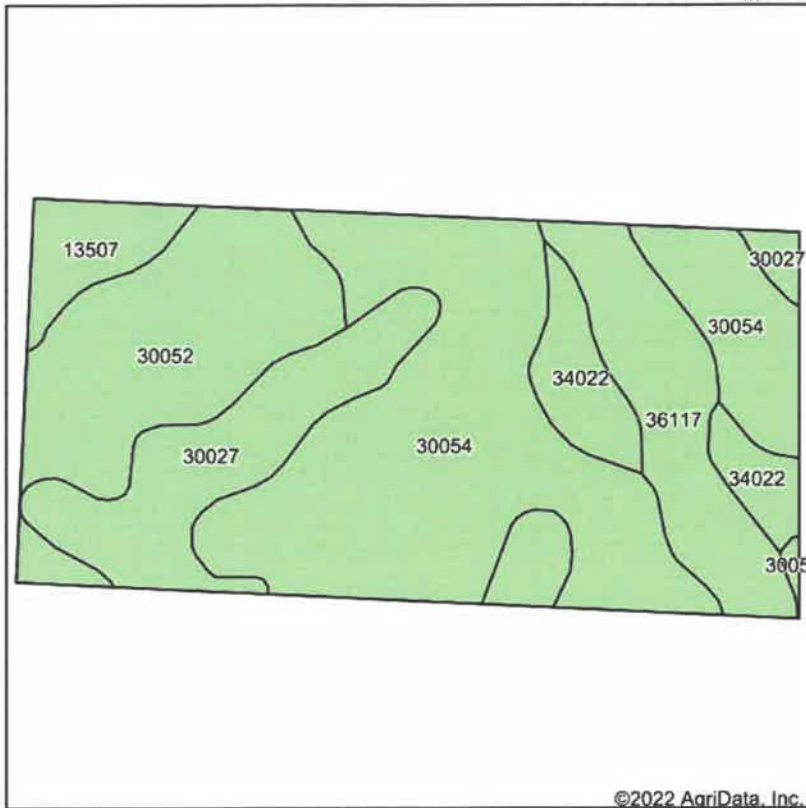

Soils data provided by USDA and NRCS.

©2022 AgriData, Inc.

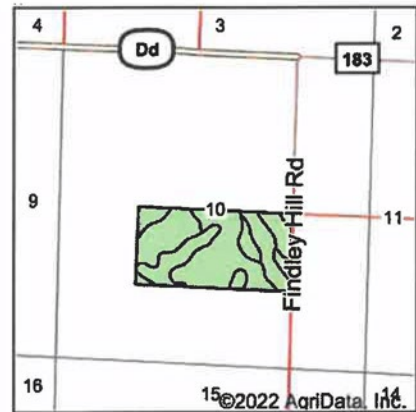

State: **Missouri**
 County: **Gentry**
 Location: **10-64N-30W**
 Township: **Howard**
 Acres: **79.98**
 Date: **7/25/2022**



NELSON REAL ESTATE

Maps Provided By:



© AgriData, Inc. 2021

www.AgriDataInc.com



Area Symbol: MO075, Soil Area Version: 24

Code	Soil Description	Acres	Percent of field	Non-Irr Class *c	Common bermudagrass Tons	Orchardgrass red clover Tons	Tall fescue Tons	Warm season grasses Tons
30054	Gara clay loam, 9 to 14 percent slopes, eroded	33.40	41.8%	IVe				
30052	Gara clay loam, 14 to 18 percent slopes, moderately eroded	15.63	19.5%	VIe				
30027	Armstrong clay loam, 5 to 9 percent slopes, moderately eroded	12.90	16.1%	IIIe				
36117	Nodaway silt loam, heavy till, 0 to 2 percent slopes, occasionally flooded	9.43	11.8%	IIw				
34022	Humeston silt loam, 1 to 4 percent slopes, rarely flooded	5.21	6.5%	IIIw	8	7	8	9
13507	Bremer silty clay loam, 0 to 2 percent slopes, rarely flooded	3.41	4.3%	IIw	8	7	8	9
Weighted Average				3.84	0.9	0.8	0.9	1

*c: Using Capabilities Class Dominant Condition Aggregation Method