

# Soils Map

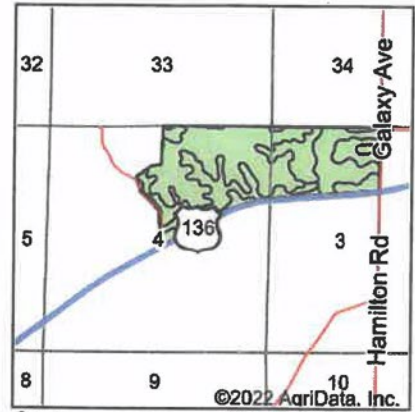

State: **Missouri**  
 County: **Mercer**  
 Location: **4-64N-25W**  
 Township: **Harrison**  
 Acres: **237.48**  
 Date: **6/15/2022**

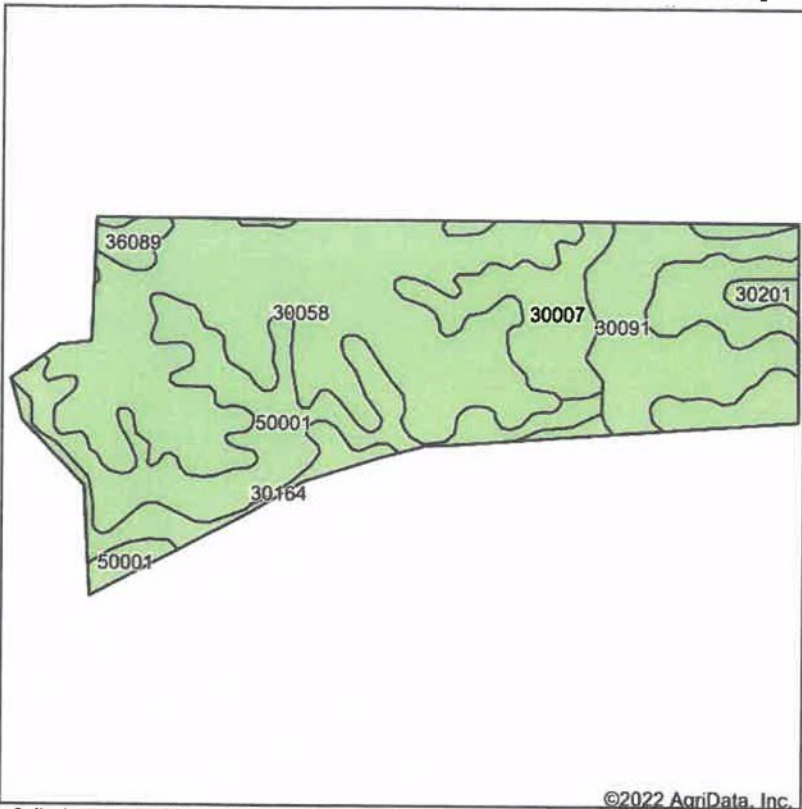

Maps Provided By:



©2022 AgriData, Inc.

Soils data provided by USDA and NRCS.

Area Symbol: MO129, Soil Area Version: 22

Code	Soil Description	Acres	Percent of field	Non-irr Class *c	Alfalfa hay Tons	Caucasian bluestem Tons	Common bermudagrass Tons	Corn	Corn Bu	Grain sorghum Bu	Orchardgrass red clover Tons	Soybeans Bu	Tall fescue Tons	Warm season grasses Tons	Winter wheat Bu
30058	Gara loam, 14 to 18 percent slopes, moderately eroded	101.65	42.8%	Vle											
50001	Armstrong loam, 5 to 9 percent slopes, eroded	46.39	19.5%	IIle	5	8	7	5	5	4	8	2	7	8	2
30091	Grundy silty clay loam, 2 to 5 percent slopes, moderately eroded	30.70	12.9%	Ile											
30007	Adair loam, 5 to 9 percent slopes, eroded	21.32	9.0%	IIle	5	8	7				8		7	8	
30133	Lamoni clay loam, 5 to 9 percent slopes, eroded	20.04	8.4%	IIle											

Soils data provided by USDA and NRCS.