

Soils Map

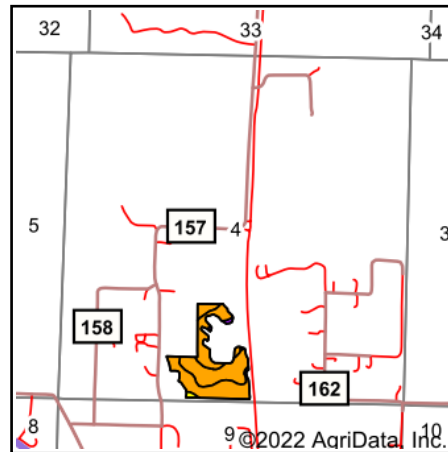
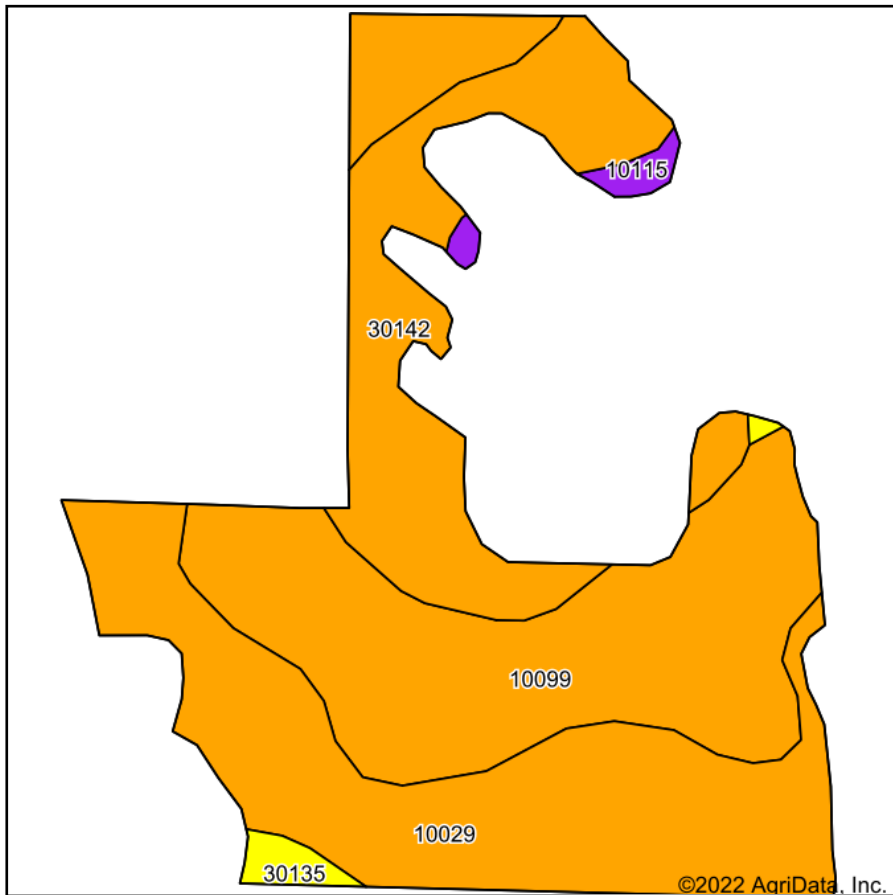

State: **Missouri**
 County: **Andrew**
 Location: **4-59N-35W**
 Township: **Nodaway**
 Acres: **20.72**
 Date: **6/3/2022**

United Country
 Property Solutions, LLC

Maps Provided By:
surety
 CUSTOMIZED ONLINE MAPPING
 © AgriData, Inc. 2021 www.AgriDataInc.com



Soils data provided by USDA and NRCS.

Area Symbol: MO003, Soil Area Version: 23

Code	Soil Description	Acres	Percent of field	Non-Irr Class Legend	Non-Irr Class *c	Alfalfa hay Tons	Caucasian bluestem Tons	Common bermudagrass Tons	Orchardgrass red clover Tons	Tall fescue Tons	Warm season grasses Tons	*n NCCPI Overall	*n NCCPI Corn	*n NCCPI Soybeans
10099	Marshall silty clay loam, 5 to 9 percent slopes, eroded	8.32	40.2%		IIIe							90	90	70
10029	Higginsville silty clay loam, 5 to 9 percent slopes, eroded	7.18	34.7%		IIIe	7	8	7	7	7	8	70	70	63
30142	Lamoni silty clay loam, 5 to 9 percent slopes, moderately eroded	4.64	22.4%		IIIe							62	62	50
30135	Lamoni clay loam, 9 to 14 percent slopes, moderately eroded	0.31	1.5%		IVe							65	65	45
10115	Rosendale silty clay loam, 9 to 30 percent slopes	0.27	1.3%		VIe	5	8	7	8	7	8	57	57	41
Weighted Average						3.05	2.5	2.9	2.5	2.5	2.9	*n 76	*n 76	*n 62.3

*n: The aggregation method is "Weighted Average using all components"

*c: Using Capabilities Class Dominant Condition Aggregation Method

Soils data provided by USDA and NRCS.