

# Soils Map

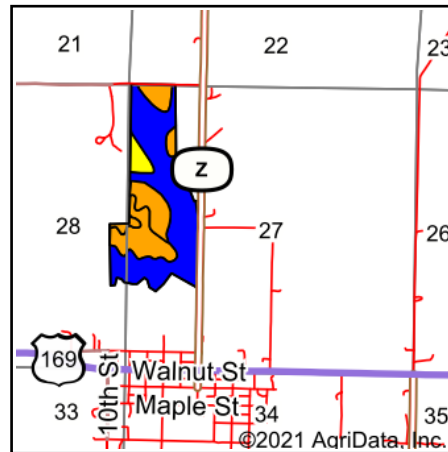
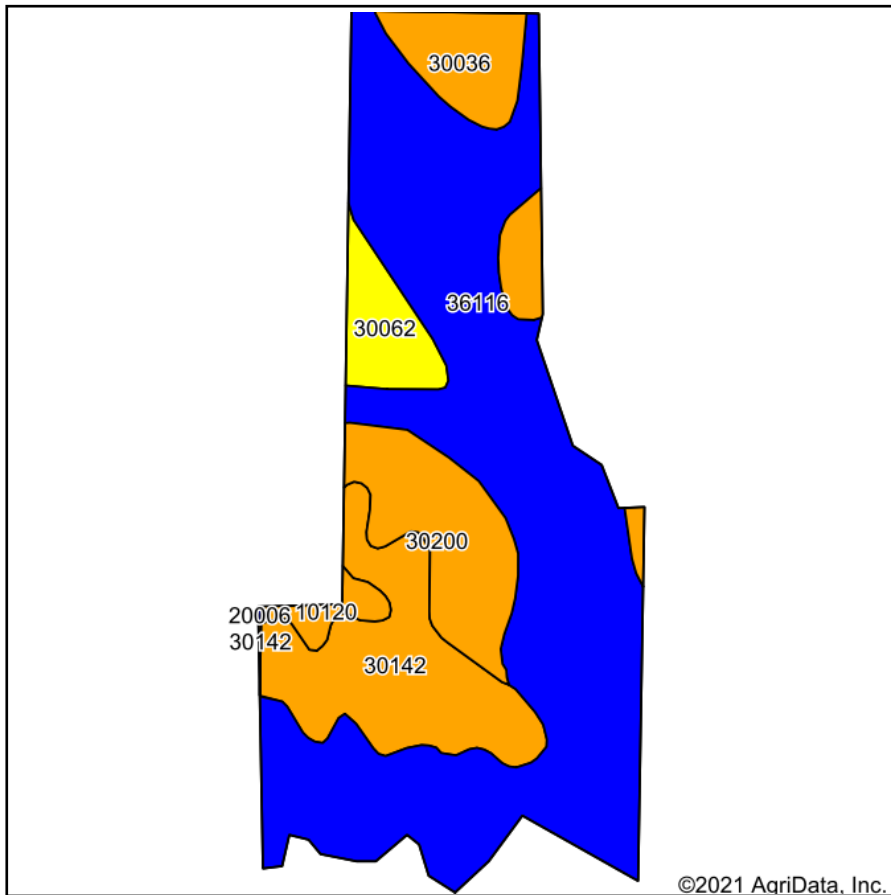

State: **Missouri**  
 County: **De Kalb**  
 Location: **27-60N-33W**  
 Township: **Polk**  
 Acres: **98.69**  
 Date: **10/5/2021**

**United Country**  
 Property Solutions, LLC

Maps Provided By:  
**surety**  
 CUSTOMIZED ONLINE MAPPING  
 © AgriData, Inc. 2021 www.AgriDataInc.com



Soils data provided by USDA and NRCS.

Area Symbol: MO003, Soil Area Version: 22  
 Area Symbol: MO063, Soil Area Version: 22

Code	Soil Description	Acres	Percent of field	Non-Irr Class Legend	Non-Irr Class *c	Alfalfa hay Tons	Caucasian bluestem Tons	Common bermudagrass Tons	Orchardgrass red clover Tons	Tall fescue Tons	Warm season grasses Tons	*n NCCPI Overall	*n NCC PI Corn	*n NCCPI Soybeans
36116	Zook silty clay loam, heavy till, 0 to 2 percent slopes, occasionally flooded	59.93	60.7%		Ilw							74	74	68
30142	Lamoni silty clay loam, 5 to 9 percent slopes, moderately eroded	15.10	15.3%		IIIe							62	62	51
30200	Shelby loam, 9 to 14 percent slopes	9.95	10.1%		IIIe							74	74	62
30036	Armstrong loam, 5 to 9 percent slopes	7.58	7.7%		IIIe	5	8	7	8	7	8	54	51	52
30062	Gara loam, 9 to 14 percent slopes	4.52	4.6%		IVe							73	73	61
10120	Sharpsburg silt loam, 2 to 5 percent slopes	1.61	1.6%		IIIs							73	73	56
<b>Weighted Average</b>						<b>2.44</b>	<b>0.4</b>	<b>0.6</b>	<b>0.5</b>	<b>0.6</b>	<b>0.5</b>	<b>*n 70.6</b>	<b>*n 70.3</b>	<b>*n 63</b>

\*n: The aggregation method is "Weighted Average using all components"

\*c: Using Capabilities Class Dominant Condition Aggregation Method

Soils data provided by USDA and NRCS.