



TType Map
03674 Kings Creek Tract
 +/- 393 acres (Taxes)
 Sec. 01,02,11-19S/20W
 Columbia Co., AR

— = property boundary

0 660 1,320
 Feet

1 in = 1,320 feet

Created By: DN
 Neeley Forestry Service, Inc.
 915 Pickett St., Camden, AR 71701
 Date: 4/14/2021

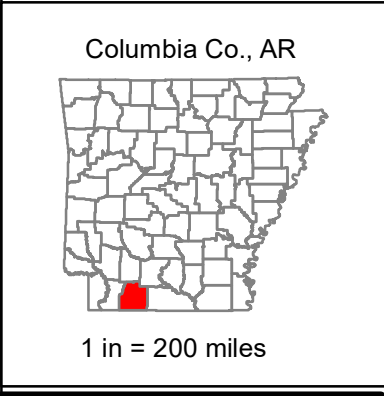
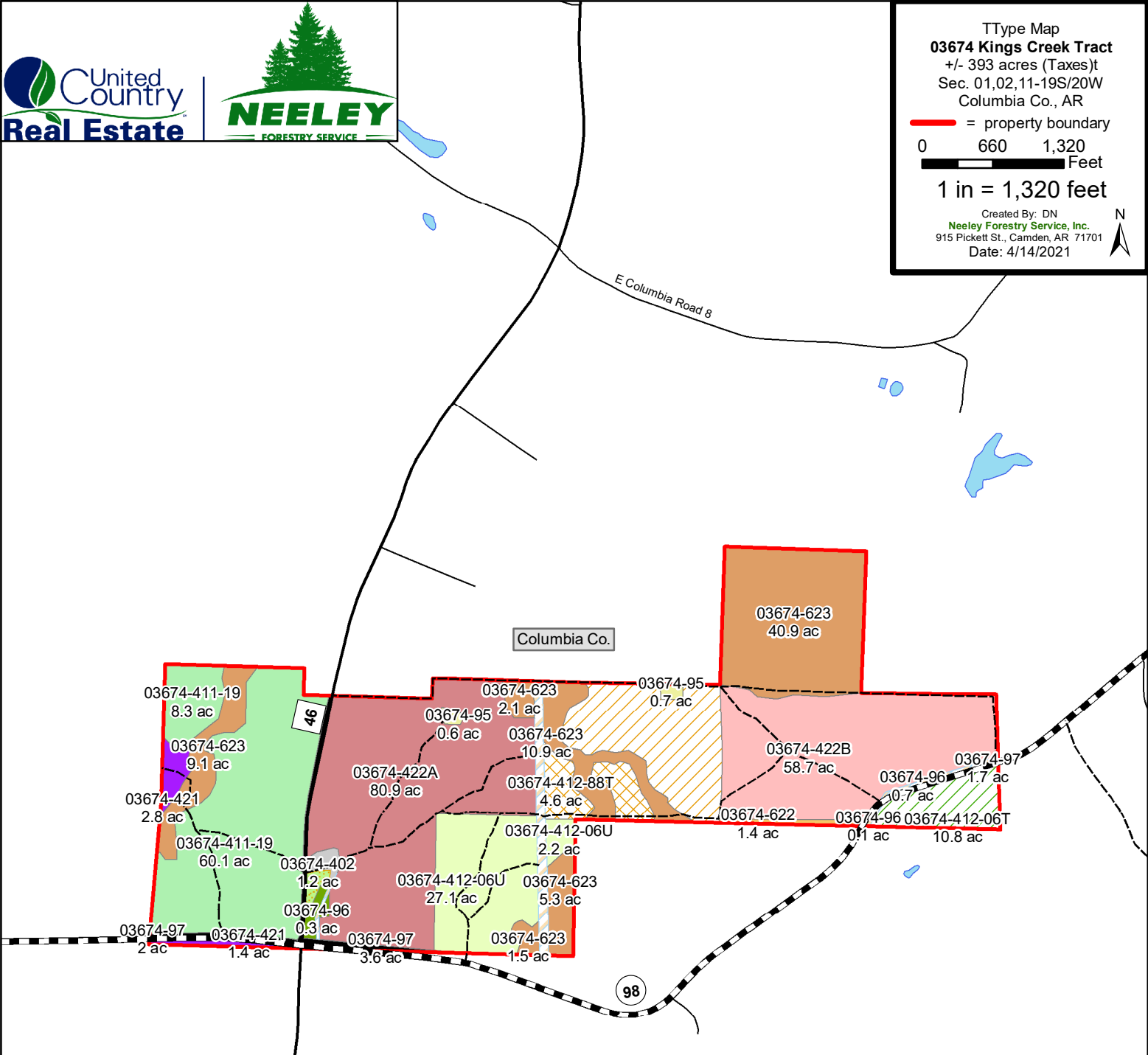

Stands_RE	
StandID	
[Pattern]	Old Field Pine, Upland (+/- 1.2 ac)
[Pattern]	1988 Planted Pine, Upland - Not 2nd Thin (+/- 28.5 ac)
[Pattern]	1988 Planted Pine, Upland - 2nd Thin (+/- 8.7 ac)
[Pattern]	~2000 Planted Pine, Upland (+/- 1.4 ac)
[Pattern]	2006 Planted Pine, Upland - Unthinned (+/- 29.2 ac)
[Pattern]	2006 Planted Pine, Upland - 1st Thin (+/- 10.8 ac)
[Pattern]	2019 Planted Pine, Flats (+/- 68.4 ac)
[Pattern]	Natural Pine, Flats (+/- 4.2 ac)
[Pattern]	Older Natural Pine, Upland (+/- 80.9 ac)
[Pattern]	Younger Natural Pine, Upland (+/- 58.7 ac)
[Pattern]	Mostly Hardwood, Upland (+/- 1.4 ac)
[Pattern]	Mostly Hardwood, Bottoms (+/- 69.7 ac)
[Pattern]	Wildlife Opening (+/- 1.3 ac)
[Pattern]	Utility Line RoW (+/- 6.1 ac)
[Pattern]	Public Road (+/- 7.2 ac)
[Pattern]	Non-Timbered, Other (+/- 1.4 ac)

Legend	
[Symbol]	Airfield
[Symbol]	Railway
[Symbol]	Woods_Roads
AR_Transportation	
[Symbol]	Streets/Roads
RTTYP	
[Symbol]	County Road
[Symbol]	State Hwy
[Symbol]	US Hwy
[Symbol]	Interstate
[Symbol]	County
[Symbol]	Ponds/Lakes
[Symbol]	City_Limits
[Symbol]	Public Land
[Symbol]	Tract

Although created with data believed to be correct, neither the accuracy nor completeness of this map are guaranteed in any manner by the seller, the seller's agents, or managers. This map is provided herein merely as an aid to prospective buyers. Prospective buyers should verify information for themselves.