



Real Estate

FULL AUCTION SERVICE AVAILABLE

THE O'CONNOR AGENCY

- SINCE 1951 -

1309 North Walnut (69 Highway), Suite A, P.O. Box 286
Cameron, Missouri 64429

Phone: (816) 632-3721 • Fax: (816) 632-5504

www.unitedcountry.com/cameronmo

James C. O'Connor, Broker • John D. O'Connor, Broker

TOWNSHIP 60N • RANGE 30W

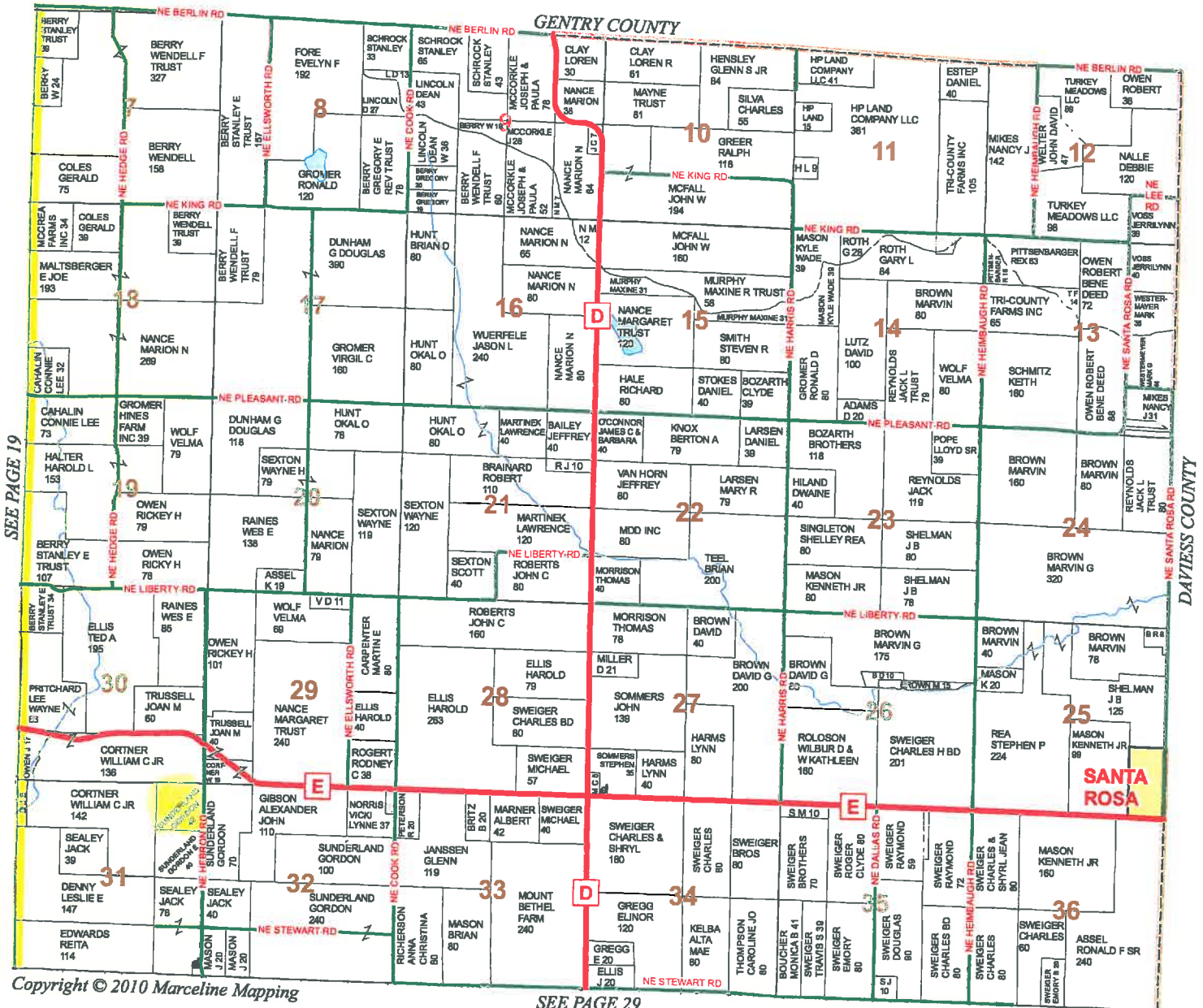

Copyright © 2010 Marceline Mapping

SEE PAGE 29

1 field, 40 acres in De Kalb County, MO

TOWNSHIP/SECTION 60N 30W - 31, 32

De Kalb County, MO

FIELD	ACRES	LOCATION	OWNER (LAST UPDATED)	OWNER ADDRESS
	39.82	60N 30W - 31, 32 APN: 000001923100000000100	(07/17/2020)	C



1 field, 40 acres in De Kalb County, MO

TOWNSHIP/SECTION 60N 30W - 31, 32

AVG NCCPI

COUNTY AVG

64.8

63.4

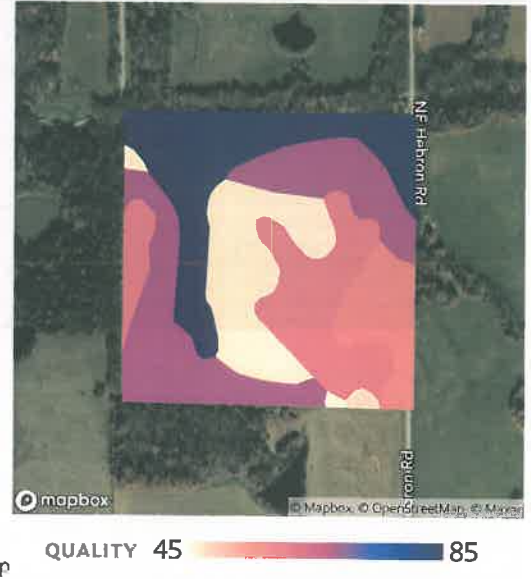
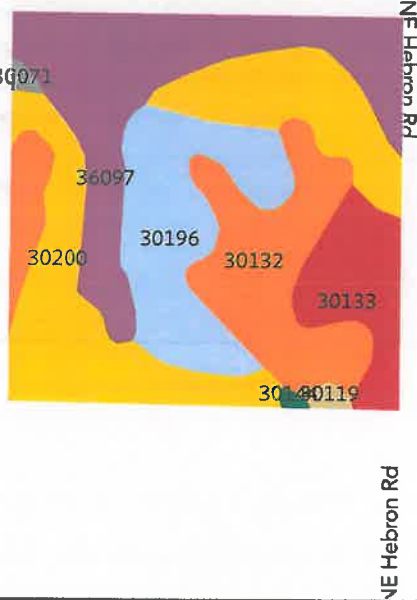

All fields

Source: NRCS Soil Survey

40 ac

SOIL CODE	SOIL DESCRIPTION	ACRES	PERCENTAGE OF FIELD	SOIL CLASS	NCCPI
30200	Shelby loam, 9 to 14 percent slopes	11.16	28.0%	3	67.8
36097	Zook silty clay loam, 1 to 4 percent slopes, occasionally flooded	9.58	24.1%	2	84.8
30132	Lamoni clay loam, 4 to 7 percent slopes	8.03	20.2%	3	58.6
30196	Shelby clay loam, 9 to 14 percent slopes, severely eroded	6.92	17.4%	4	45.9
30133	Lamoni clay loam, 5 to 9 percent slopes, moderately eroded	3.64	9.2%	3	56.7
30119	Lagonda silty clay loam, 2 to 5 percent slopes, eroded	0.22	0.6%	3	47.0
30071	Gosport-Gasconade complex, 14 to 30 percent slopes	0.17	0.4%	7	20.9
30144	Lamoni soils, 5 to 9 percent slopes, severely eroded	0.10	0.3%	4	30.9
		39.82			64.8