

Topo Map
#03490 Prairie Island RD
 +/- 90.4 acres (Deed)
 Sec. 09,10-17S/10W
 Bradley Co., AR
 = property boundary
 1 in = 2 miles
 0 1 2 Miles
 Created By: DN
 Neeley Forestry Service, Inc.
 915 Pickett St., Camden, AR 71701
 Date: 3/11/2020

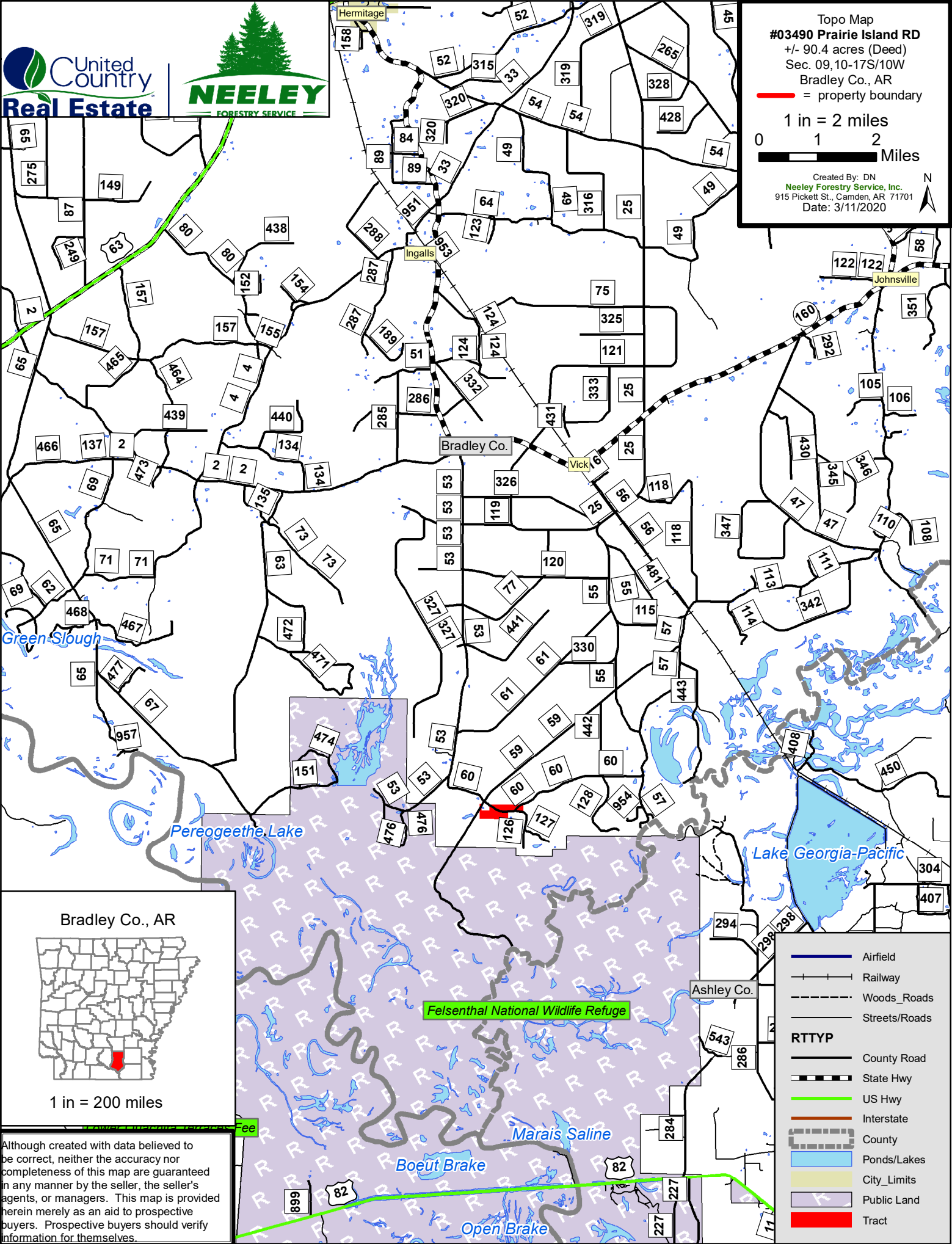

Although created with data believed to be correct, neither the accuracy nor completeness of this map are guaranteed in any manner by the seller, the seller's agents, or managers. This map is provided herein merely as an aid to prospective buyers. Prospective buyers should verify information for themselves.

	Airfield
	Railway
	Woods_Roads
	Streets/Roads
RTTYP	
	County Road
	State Hwy
	US Hwy
	Interstate
	County
	Ponds/Lakes
	City_Limits
	Public Land
	Tract