

No part of the subject tract lies within the 100 year flood plain as scaled from F.I.R.M. Panel 480739 0001 A, dated December 27, 1977.

LINE	BEARING	DISTANCE
L1	S 29°24'34" E	15.00'

Handwritten notes:  
 457.90'  
 85.23'  
 543.13'

Point of Beginning  
 N 59°17'07" E  
 30' INGRESS/EGRESS EASEMENT  
 457.90'  
 HENRICHSON AND, JOHN R. CALDWELL, JR., 1584-195  
 HARLAN  
 1/2"SRF  
 1/2"SRF  
 N 60°35'26" E  
 85.23'  
 1/2"SRF  
 1/2"SRF

2.578 ACRES  
 LOT 1, BLOCK 1

CALLED 3,000 ACR  
 WINDELL SEARCY et  
 1287-753

F. M. Highway 2493 (100')  
 N 41°24'09" W  
 (bearing Basis)  
 1/2"SRF

182.03'  
 1/2"SRF  
 S 60°33'05" W  
 262.11'  
 1/2"SRF  
 CALLED 2,000 ACRES  
 TERRY ROGER DUNFORD and wife,  
 NIKKI LYNN DUNFORD  
 1507-664

N 41°10'56" W  
 108.66'  
 1/2"SRF

1/2"SRF  
 S 86°13'55" W  
 133.86'  
 1/2"SRF  
 CALLED 132.  
 R. COOPER  
 1335-275

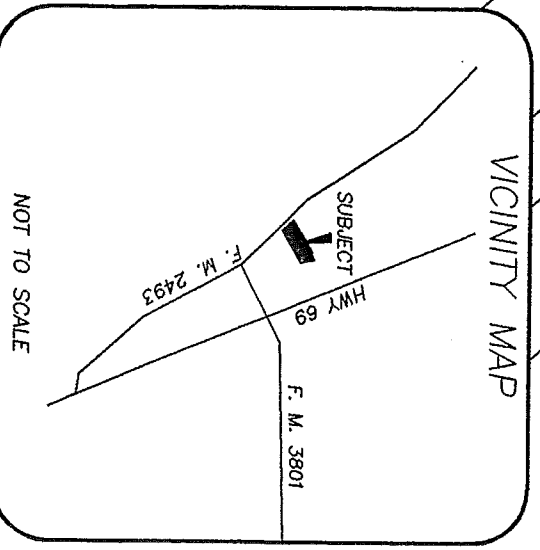

60'

STATE OF TEXAS  
 COUNTY OF CHEROKEE  
 I, Ray L. Vannoy, REGISTERED PROFESSIONAL LAND SURVEYOR  
 hereby certify that this plat was prepared from an actual sur-  
 vey of the ground under my direction and supervision during the month  
 of \_\_\_\_\_ day of \_\_\_\_\_  
 1988.



Ray L. Vannoy  
 R.P.L.S. No. 1988

Notary Public in and for  
 State of Texas

Before me, the undersigned authority, on this \_\_\_\_\_ day of \_\_\_\_\_  
 1988, appeared Roy L. Vannoy to acknowledge the above, which witness my  
 hand and seal this \_\_\_\_\_ day of \_\_\_\_\_  
 1988.

Notary Public in and for  
 State of Texas

Before me, the undersigned authority, on this \_\_\_\_\_ day of \_\_\_\_\_  
 1988, appeared Roy L. Vannoy to acknowledge the above, which witness my  
 hand and seal this \_\_\_\_\_ day of \_\_\_\_\_  
 1988.

